

# The High-Security Series

HS427-S • HS430-S

Full-Height Turnstile (Single) • Interior & Exterior Application

HS439-S • HS448-S

www.TURNSTILES.us distributes the most reliable full-height turnstiles available. The High-Security Series units can be engineered to meet all your security and control requirements, and can be created as stand-alone units, or as part of an integrated system. Available in stainless steel, powder coat or a hot-dipped galvanized finish, these units can be fitted for any application with leading edge technology and features.

## Controls and Interfaces

- Biometric Integration
- Card Readers
- Electronic/LCD Counters
- Metal Detection
- Fail-Open or Fail-Secure Locking
- Push-Button and Wireless Remotes
- Manual Key Override – both directions
- Indicator Lights



## Size Options

(pedestrian clearance):

HS427-S: 27" (686mm)

HS430-S: 30" (782mm)

HS439-S: 39" (991mm)

HS448-S: 48" (1219mm)

304 Stainless,  
No. 4 Satin finish (shown)

Also available in  
hot-dipped galvanized or  
powder coat finishes.

	Depth	Width	Passage Width	Passage Height	Overall Height
	A*	B*	C*	D*	E*
HS427-S	54" 1372mm	62" 1575mm	27" 686mm	84" 2134mm	91" 2311mm
HS430-S	56" 1422mm	66" 1676mm	30" 762mm	84" 2134mm	91" 2311mm
HS439-S	68" 1727mm	84" 2134mm	39" 990mm	84" 2134mm	91" 2311mm
HS448-S	93" 2362mm	106" 2692mm	48" 1219mm	84" 2134mm	91" 2311mm

\* See CAD drawings on reverse side.

8641 South Warhawk Road Conifer, CO 80433  
(303) 670-1099 Patrick.McAllister@TURNSTILES.us



# The High-Security Series

HS427-S • HS430-S

## Full-Height Turnstile (Single) • Interior & Exterior Application

HS439-S • HS448-S

### Applications:

Ideal for controlling orderly flow of foot traffic in both indoor and outdoor settings

### Product Features:

Materials and Finishes available in your choice of:

- Hot dipped galvanized carbon steel
- Polyester enamel on carbon steel (standard color is black/ other colors available upon request)
- Our signature 304 Stainless steel/ No. 4 satin finish

### Design & Construction:

- Designed for secure operation with aesthetics in mind
- Featuring fully welded exterior components
- Minimal exposed hardware
- Heavy gauge materials meeting ASTM standards

### Controller &

#### Access Control Operation:

- Self-centering control head with adjustable hydraulic shock suppression
- Hardened tool steel locking bars, cam and roller assemblies
- Permanently lubricated bearings
- All units are available in clockwise, counter-clockwise or bi-directional passage

### Measures:

#### HS427-S

Size of opening (pedestrian clearance)

HS427-S 27" (686mm)

#### Arm and Barrier Tubing Sizes

1 1/2" diameter 14 gauge (38mm) - Standard

1 3/4" diameter 14 gauge (44mm) - Optional

Width	Depth
62" (1575mm)	54" (1372mm)

#### HS430-S

Size of opening (pedestrian clearance)

HS430-S 30" (762mm)

#### Arm and Barrier Tubing Sizes

1 1/2" diameter 14 gauge (38mm) - Standard

1 3/4" diameter 14 gauge (44mm) - Optional

Width	Depth
66" (1676mm)	56" (1422mm)

Measures: (continued)

#### HS439-S

Size of opening (pedestrian clearance)

HS439-S 39" (991mm)

#### Arm and Barrier Tubing Sizes

1 3/4" diameter 14 gauge (44mm)

Width	Depth
84" (2134mm)	68" (1727mm)

#### HS448-S

Size of opening (pedestrian clearance)

HS448-S 48" (1219mm)

#### Arm and Barrier Tubing Sizes

1 3/4" diameter 14 gauge (44mm)

Width	Depth
106" (2692mm)	93" (2362mm)

### All models:

- Overall exterior height 91" (2311mm)
- Pedestrian walk through height 84" (2134mm)

### Options:

- Electronic locking module featuring heavy-duty 24 vdc pull-type industrial solenoids and card reader interface
- Available in Fail-Safe (open on power failure) or Fail-Lock (lock on power failure modes)
- Can interface with card readers, computer attendance systems, coin and token acceptors, push buttons, wireless remote controls and metal detectors
- Electronic 6 digit resettable counter with LCD display and ten-year lithium battery
- Vertical Graphic Array (VGA) red x / green arrow
- Additional options available on request

### Matching Swing Gate available

(see model HS336 Manual Passage Gate information)

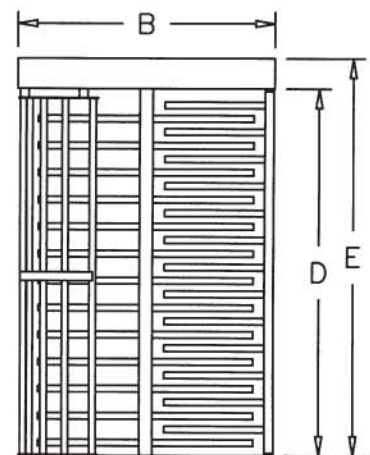
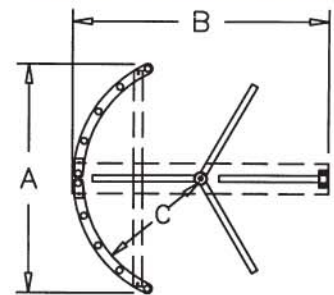

### Electrical Specifications:

Command module input 110-240 VAC (2 amp-1 amp) 50-60 Hz; control voltage 24 VDC. All electrical components are UL recognized and CSA certified.

### Standards and Codes:

Austenitic stainless steel: ASTM A240, A249, A276

Hot rolled steel: AISI C-1020, AISI C-1018

Hot dipped galvanizing: ASTM A-143, ASTM A-153-80

Stainless steel fasteners: ASTM A-320

American Welding Society (AWS) Standard D 1.1

### Warranty:

Units are warranted against defects in materials and workmanship for a period of five years from date of delivery. See warranty information for specific details.